

Y7S623F528			
EDITION	A	DATE	20161209

258 ± 2

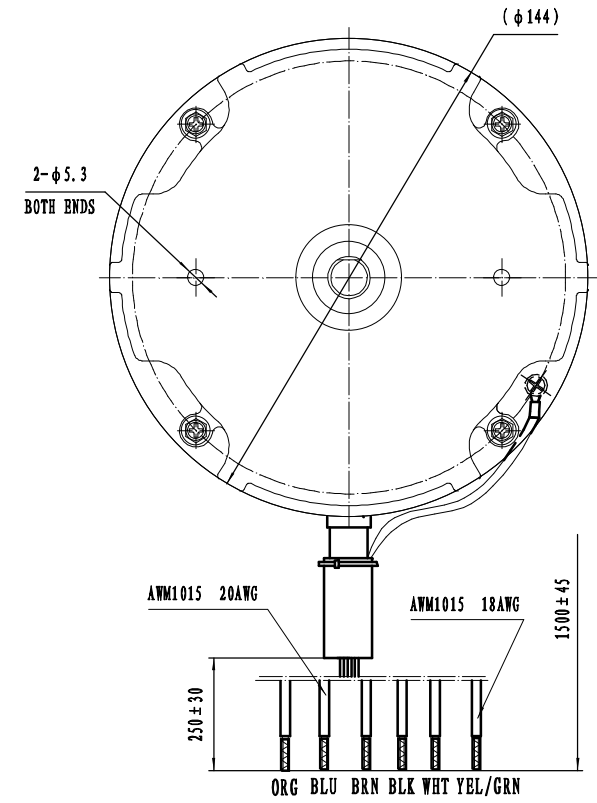

CONNECT DIAGRAM

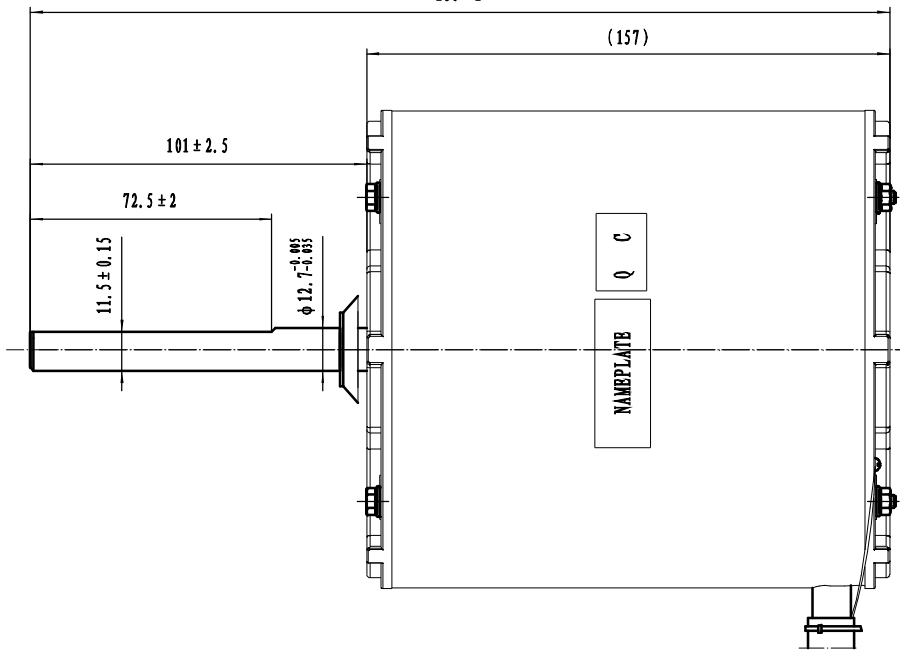
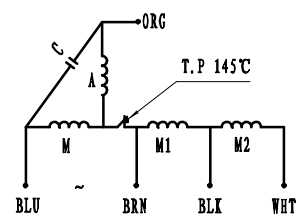

 BROAD-OCEAN	 TECHTOP	WIRE DIAGRAM 
	Y7S623F528 (TBR6A037BSM) 240V 50Hz AMP2.4 6P PH1 CL:B	
	370W RPM890/3SPD CAP:12μF/440VAC THERMALLY-PROTECTED ROT	
	WWW.TECHTOP.COM.AU	

TECHNIC REQUIREMENT

1. MOTOR RUNS WELL.
2. 240V 50Hz 12μF/440V RPM890 6P CL:B
3. ROTATION CCW
4. ENDPLAY: 0.3-2.0;
5. BALL BEARING (C&U OR WHRBC OR NZSB OR SXA AND SO ON)

					TBR6A037BSM			ZHONGSHAN BROAD-OCEAN MOTOR CO., LTD.	
NO.	MARK	ALTERATION	SIGN	DATE					
DESIGN	ZhiYun Li	STANDARDIZATION			PHASE	WEIGHT	SCALE		
DRAWING							1:1		
PROOFREAD		AUDITING			AGGREGATELY		NO.		
TECHNICS		APPROVE					OUTLINE		