

Y7S423E030

EDITION 01 DATE 20170119

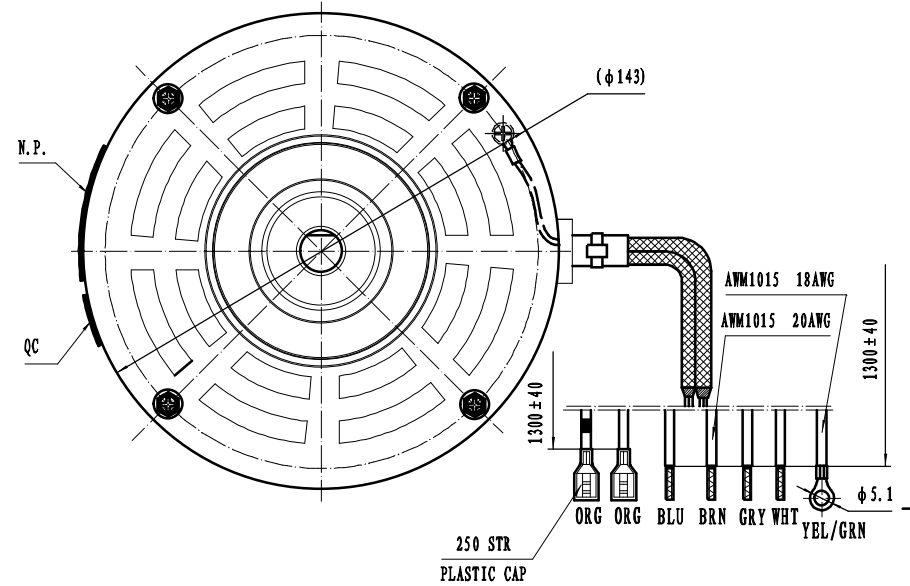

CONNECT DIAGRAM

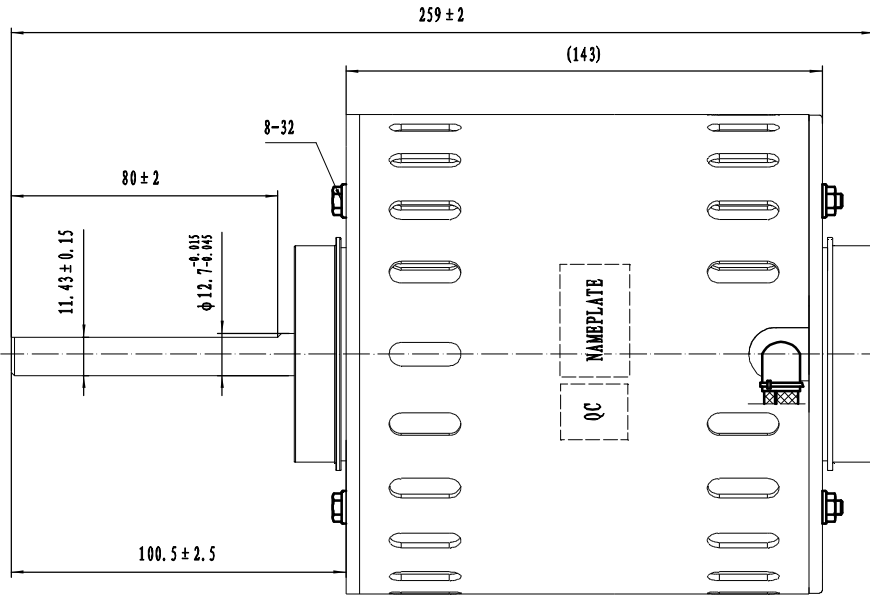
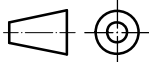
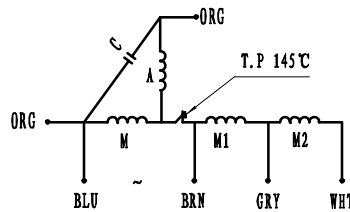

		Y7S423E030 (TBR4A060RSM) 240V 50Hz AMP4.6 4P PHI CL: B 670W RPM1200/3SPD CAP: 15 μ F/440VAC THERMALLY-PROTECTED ROT WWW.TECHTOP.COM.AU	

TECHNIC REQUIREMENT

1. MOTOR RUNS WELL.
2. 240V 50Hz 15 μ F/440V RPM1200 4P CL: B
3. ROTATION CCW
4. ENDPLAY: 0.3-2.0;
5. BALL BEARING (C&U OR WHRBC OR NZSB OR SXA AND SO ON)

					TBR4A060RSM			ZHONGSHAN BROAD-OCEAN MOTOR CO., LTD.	
NO.	MARK	ALTERATION	SIGN	DATE					
DESIGN	ZhiYun Li	STANDARDIZATION			PHASE	WEIGHT	SCALE		
DRAWING							1:1		
PROOFREAD		AUDITING			AGGREGATELY		NO.		
TECHNICS		APPROVE							
								OUTLINE	